

# standIVARIUS

## Wireless mouse user instructions

### Installing the battery

The optical mouse uses one AA alkaline or rechargeable battery.

1. Open battery compartment
2. Insert the battery as indicated inside the compartment
3. Replace cover

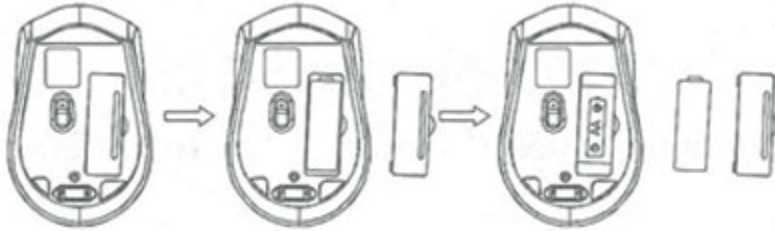

### Connecting the receiver

1. Remove USB nano receiver from the rear of mouse
2. Connect USB receiver to USB port on computer
3. Plug and Play technology - no driver is required
4. Mouse features intelligent power saving - move or click mouse to reactivate

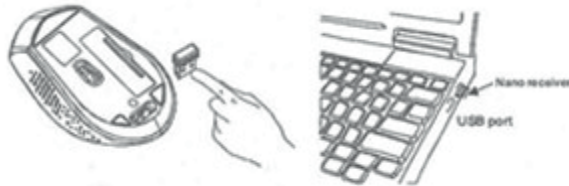

### Transporting your wireless mouse

1. Remove USB nano receiver from your computer to turn off the mouse
2. Store USB nano receiver in base of mouse in transit



### Restoring connection

In the event of the mouse losing communication with the receiver:

1. Connect USB nano receiver to USB port on computer
2. To restore mouse remove and replace battery in mouse close to the receiver

### DPI settings

Use DPI button to select fast-medium-slow DPI setting specific to the task.

